

KolibriTM

ROOK

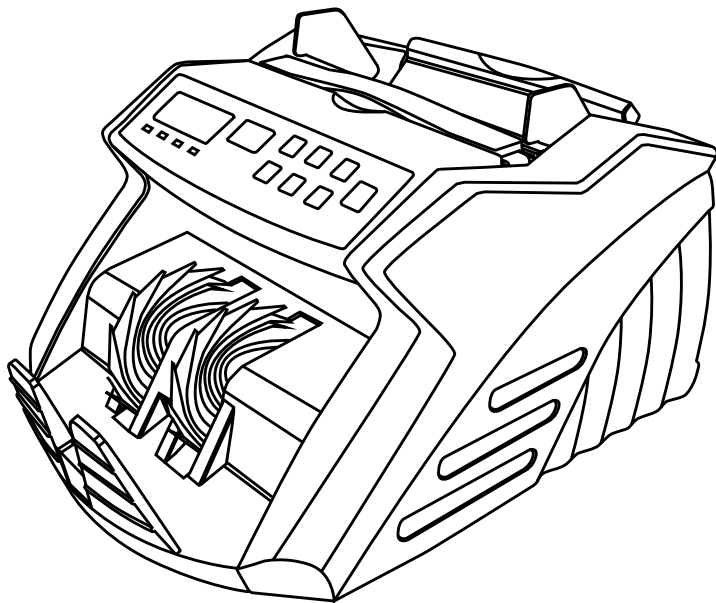

USER MANUAL
Rook Currency Counter

This manual contains important information on safety measures and operational features. Please read it carefully before operating your currency counter and keep it for future reference.

If you have questions about your Kolibri Rook and its operation, please contact technical support at www.kolibriusa.com.

Table of contents:

1. INTRODUCTION

1.1	ABOUT THE KOLIBRI ROOK	1
1.2	BOX CONTENTS	1
1.3	VIEWS OF THE KOLIBRI ROOK	2
1.4	CONTROL PANEL	4
1.5	SPECIFICATIONS	5
1.6	IMPORTANT SAFETY NOTES	5

2. GETTING STARTED

2.1	POWERING UP	6
2.2	LOADING THE HOPPER	6
2.3	CARRYING THE UNIT	6

3. OPERATING MODES

3.1	COUNT MODE	7
3.2	BATCH MODE	7
3.3	ADD MODE	8
3.4	ADD + BATCH MODE	8

4. DETECTION FEATURES

4.1	UV COUNTERFEIT DETECTION	8
4.2	MG COUNTERFEIT DETECTION	9
4.3	DOUBLE NOTE DETECTION	9
4.4	HALF NOTE DETECTION	9
4.5	CHAIN NOTE DETECTION	10

5. MAINTENANCE, TROUBLESHOOTING, WARRANTY, CONTACT INFORMATION

5.1	MAINTENANCE	10
5.2	TROUBLESHOOTING	11
5.3	WARRANTY	12
5.4	CONTACT INFORMATION	12

1. INTRODUCTION

1.1 ABOUT THE KOLIBRI ROOK

The Kolibri Rook currency counter is a cash processing machine that is sophisticated yet simple to operate. It will save you time and reduce counting errors by swiftly and precisely counting stacks of bills at speeds up to 1,400 bills per minute. The Kolibri Rook will allow you to batch your desired amount of bills into separate stacks. All of these features come with a built-in counterfeit detection system that uses ultraviolet and magnetic ink detection which will alert the user of any suspicious bills.

1.2 BOX CONTENTS

- Kolibri Rook Currency Counter
- Power cord
- User manual

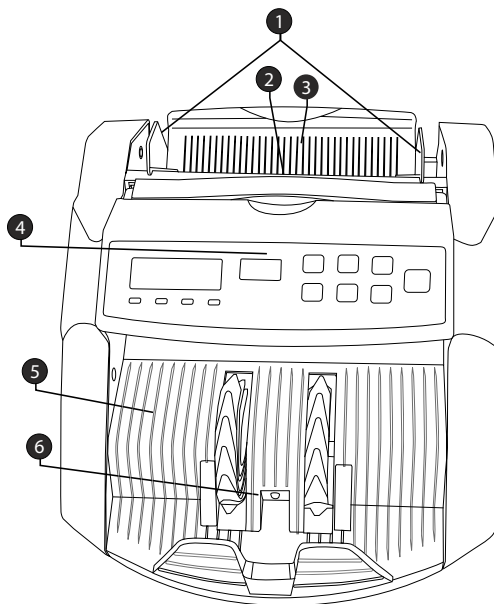

- ❶. Bill Guides
- ❷. Hopper Sensor
- ❸. Hopper
- ❹. Control Panel
- ❺. Stacker
- ❻. Stacker Sensor

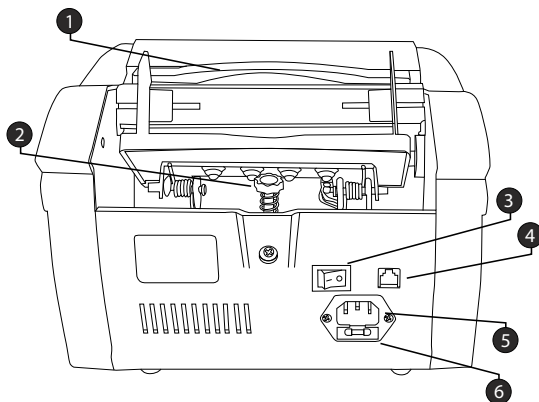

- ❶. Carrying Handle
- ❷. Feed Gap Adjuster
- ❸. Power Switch
- ❹. RJ11 Port
- ❺. AC Power
- ❻. Fuse

1.4 CONTROL PANEL

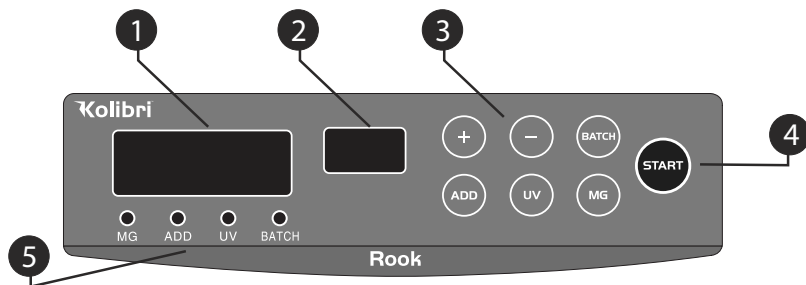

Control panel	
Key	Function
①. Primary Display	Shows total count
②. Secondary Display	Shows stacker count
③. Control Buttons	Controls settings including batch and detection modes
④. Start Button	Starts the count (when not in auto-start mode)
⑤. Indicators	Indicates modes and counterfeit detection settings

1.5 SPECIFICATIONS

Counting speed:	1400 bills/min
Hopper capacity:	300 new or 200 circulated
Stacker capacity:	300 new or 200 circulated
Weight:	12 lb (5.4 kg)
Dimensions:	9.7" w x 11.5" d x 7" h (246 x 292 x 177mm)
Power source:	110V 60Hz <70W

1.6 IMPORTANT SAFETY NOTES

When using this product, basic safety precautions should always be followed, including the following:

- Do not use this product in areas where it may be exposed to water or any other liquids.
- Unplug this product from the wall outlet before cleaning. Use a damp cloth or air duster to clean the unit.
- To avoid the risk of electrical shock, do not disassemble this unit. Disassembling will expose you to dangerous voltages and other safety risks. Incorrect reassembly may cause electrical shock when the unit is subsequently used.
- Only use the power cord supplied with the unit. Plug the power cord into a properly grounded wall outlet. Do not remove the ground pin from the power cord. Failure to properly ground the unit can result in severe injury or fire.
- Make sure the device is installed on a flat surface. Do not operate the unit in areas with high temperature, humidity or smoke as these conditions may impede performance.
- This product is designed for indoor use in a ventilated environment. Keep the unit away from direct sunlight and strong magnetic fields which may interfere with the counterfeit detection sensors.
- When not using the unit for an extended period of time, disconnect the power cord from the wall outlet.

2. GETTING STARTED

2.1 POWERING UP

Please make sure the hopper and stacker are empty and turn the power switch on. The unit will conduct a self-check by spinning the counting wheels several times. The screen will display "0" when the unit is ready to operate.

2.2 LOADING THE HOPPER

Loading the hopper correctly is important in order to avoid jams and speed up the operation of the unit. Follow the steps as shown below to properly load bills into the hopper.

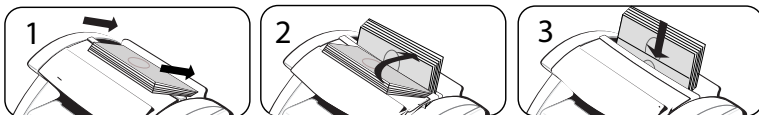

2.3 CARRYING THE UNIT

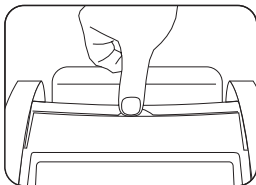

1. Grasp handle

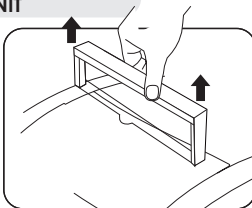

2. Pull handle up

3. OPERATING MODES

3.1 COUNT MODE

After turning the machine on it will default to Count mode.

To return to Count mode from another mode, press the ADD and BATCH buttons until both ADD and BATCH indicators are turned off.

To count bills, place them in the hopper and follow the procedure described in 2.2 Loading the Hopper. The machine will start counting automatically and will move the bills from the hopper to the stacker as it counts them. The machine will stop counting when the hopper is completely emptied. The counted number of bills will be displayed. Remove the bills that have been counted from the stacker and any additional bills to be counted into the hopper. The Screen will clear itself of the previous count before counting the new stack.

3.2 BATCH MODE

To switch to Batch mode, press the BATCH button. You may press the BATCH button repeatedly to cycle through different preset batch quantities, or you may use the "-" and "+" buttons to manually select your desired batch size.

The machine will start counting automatically after bills are placed in the hopper. When it reaches the set batch amount it will automatically stop and the number of bills counted will be displayed on the screen. When the stacker is emptied, the machine will automatically continue to count up to the preset batch amount again.

If hopper runs out of bills before a batch is completed, the machine will emit three beeps and flash the current count on screen. At this point the user may add bills to the hopper to complete the batch, or remove the incomplete batch from the machine.

3.3 ADD MODE

In this mode the unit will count multiple stacks of bills while keeping track of the total amount of bills counted. To switch to Add mode, press the ADD button until the ADD indicator is illuminated.

Following the procedure described in section 2.2 LOADING THE HOPPER, place the first stack of bills to be counted into the hopper. The unit will start counting automatically. The number of bills will be displayed on screen. When ready to count the next stack of bills, empty the stacker and add the new stack to be counted into the hopper. The unit will continue counting and add the new count to the total.

3.4 ADD + BATCH MODE

This mode batches the desired quantity of bills and monitors the running total at the same time. To activate this mode press the ADD button to illuminate the ADD indicator, and use the BATCH and "-" and "+" buttons to select your desired batch size.

The machine will display the batch size on the left and the total on the right.

4. DETECTION FEATURES

4.1 UV COUNTERFEIT DETECTION

The Kolibri Rook is able to identify counterfeit bills using ultraviolet light. This function is available in all modes by pressing the UV button until the UV indicator is illuminated.

When a suspect bill is detected the unit will beep three times and display the letter "A." The unit will continue to beep until the suspect bill is removed from the stacker.

Please note that a suspect UV bill does not necessarily mean that the bill is counterfeit. There are several reasons a genuine bill may be recognized as counterfeit. Possible reasons for a bill to be indicated as suspect include: direct sunlight exposure, worn out bill, excessively dirty bill or advanced counterfeiting techniques used to produce the bill. Separate equipment may be required to determine definitively whether or not a note is counterfeit.

4.2 MG COUNTERFEIT DETECTION

The Kolibri Rook is also able to identify counterfeit bills using magnetic ink detection. This function is available in all modes by pressing the MG button until the MG indicator is illuminated.

When a suspect bill is detected the unit will beep three times and display the letter “b.” The unit will continue to beep until the suspect bill is removed from the stacker.

Please note that a suspect MG bill does not necessarily mean that the bill is counterfeit. There are several reasons a genuine bill may be recognized as counterfeit. Possible reasons for a bill to be indicated as suspect include: direct sunlight exposure, worn out bill, excessively dirty bill or advanced counterfeiting techniques used to produce the bill. Separate equipment may be required to determine definitively whether or not a note is counterfeit.

4.3 DOUBLE NOTE DETECTION

Bills may stick to each other due to excessive dirt, folding or various other reasons. The Kolibri Rook uses infrared light based technology to determine whether two bills are stuck together. This feature is active automatically in all modes.

If a double bill is encountered the unit will beep three times and display “dbl.” The unit will continue beeping until action is taken. To clear the error, all bills must be removed from the stacker and recounted.

4.4 HALF NOTE DETECTION

The Kolibri Rook incorporates infrared light sensors that notify users if a half note passes through the counting mechanism. This feature is activated automatically in all modes.

If the unit detects a half note, it will beep three times and display “HLF” on screen. The unit will continue beeping until action is taken. To clear the error, all

bills must be removed from the stacker and recounted.

4.5 CHAIN NOTE DETECTION

The Kolibri Rook utilizes a self-checking system that alerts the user in rare cases when several notes pass through the counting mechanism at once. This feature is activated in all modes.

If the unit detects a chain error, it will beep three times and display “Chn.” The unit will continue beeping until action is taken. To clear the error, all bills must be removed from the stacker and recounted.

4. MAINTENANCE AND TROUBLESHOOTING

5.1 MAINTENANCE

ATTENTION: The unit should always be turned off and disconnected from its power cord before cleaning.

Most operational problems can be avoided by regular care and preventative maintenance. Taking regular care of your currency counter will significantly increase its lifetime.

To avoid problems, make sure there are no metal clips or rubber bands in the bills being counted. Be sure to follow the proper procedure for loading the hopper, refer to section 2.2 LOADING THE HOPPER.

To get the best results from your counter, it is recommended that you use an air duster and a soft bristle brush to remove any dust or debris from the interior of the unit. When not using the machine for an extended period of time, cover it with a cloth or plastic sheet to prevent dust from settling inside.

5.2 TROUBLESHOOTING

Error message display:

Error code	Cause	Solution
A	Suspect bill detected.	Remove the last bill from the stacker and press the START button to continue counting. The suspect bill will not be added to the count. Refer to section 4.1 for more details.
b	Suspect bill detected.	Remove the last bill from the stacker and press the START button to continue counting. The suspect bill will not be added to the count. Refer to section 4.2 for more details.
dbl	The last counted bill is a double note.	Remove the double note from the stacker and recount all other notes in the stacker. Refer to section 4.3 for more details.
HLF	A half bill was detected.	Remove the half bill from the stacker and recount all other notes in the stacker. Refer to section 4.4 for more details.
[chn	Two or more notes have passed through the unit at the same time.	Remove all bills from the stacker and recount them. Refer to section 4.5 for more details.
EA 0 EA 1	Counting sensors may have collected dust.	Clean the sensor with a soft bristle brush and compressed air. Refer to section 5.1.
EA 2	There are bills in the stacker.	Remove the bills from the stacker to allow the machine to complete its self-check.
	Stacking sensors may have collected dust.	Clean the sensor with a soft bristle brush and compressed air. Refer to section 5.1.

Other possible errors:

Problem description	Cause/Action
Does not function after unit turned on.	Ensure the power cord is connected properly.
Machine fails to detect counterfeit notes.	The UV sensor may have collected dust. Refer to the Maintenance section 5.1.
The count result is less than the real number of bills.	1. Bills were incorrectly inserted into the hopper. 2. The feeding gap is too wide. This may happen when brand new notes are counted, because their thickness differs greatly from used notes to which machines's gap is adjusted by default. Narrow the gap a little bit by turning the feed gap adjuster (refer to part 1.3, rear and front view) clockwise and try counting again. Repeat the procedure until a suitable gap width is reached.
Bills are jammed.	Turn off the machine. Remove any jammed bills by turning rollers or wheels manually if necessary. Look for any foreign objects inside the unit (paper clips, rubber bands, etc.) Remove foreign objects, if any. Turn the unit on and restart counting.

5.3 WARRANTY

The Kolibri Rook is warranted for a period of one year from the date of purchase. In most cases a unit malfunction can easily be corrected by performing a thorough cleaning. This requires disassembly of the unit to clean each individual sensor. This cleaning is not covered by warranty and should be performed only by a qualified technician.

The warranty does not cover shipping to Kolibri's technical service center.

5.4 CONTACT INFORMATION

www.kolibriusa.com

Kolibri

©2018 Printed in China.
Specifications subject to change without notice.
www.KolibriUSA.com

FNDOMINO082018